

HD MAGNUM[®]

HDM35 GEAR MOTORS

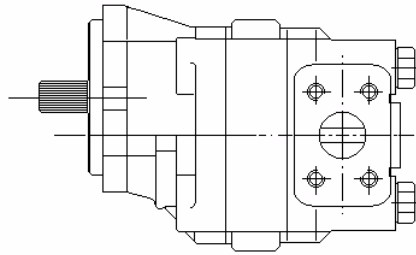
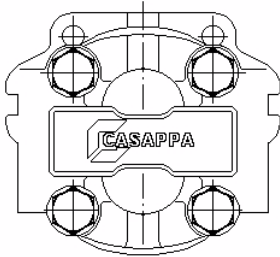

Part No.	Displacement cm ³ /rev	MAX PRESS URE	RPM		Output kW	Torque NM
		P1			at 100 BAR and 1000 RPM	
		BAR	Max	Min		
HDM35-40R1-06S8-OFOF	40.46	230	3000	400	5.0	50
HDM35-50R1-06S8-OFOF	50.77				6.3	60
HDM35-63R1-06S8-OFOF	63.46				7.9	75
HDM35-71R1-06S8-OFOF	71.92	213	2700	400	9.0	86
HDM35-80R1-06S8-OFOF	80.39				10.2	97
HDM35-90R1-06S8-OFOF	90.96	196	2500	250	11.5	110
HDM35-100R1-06S8-OFOF	99.43	179			13.1	125
HDM35-112R1-06S8-OFOF	112.12	162			14.7	140
HDM35-125R1-06S8-OFOF	124.81	145			15.9	152

SERIES HDM35-50 R 1- 06 S8 - OFOF
DISPLACEMENT CODE

Rotation Code	SHAFT TYPE	Shaft Code	Mount Code	Port Code
S = Counterclockwise D = Clockwise R = Reversible	1 = SOLID SHAFT 2 = STUB SHAFT	06 = 1 1/4" 14 Tooth 34 = 1 1/4" Keyed	S4 = SAE "B" 4 BOLT S8 = SAE "C" 2/4 BOLT	OF = 1 5/16" Oring Boss

NB: Listed pressures are for reversible motors, for single rotation motors refer to pump figures.

NB: Output kW and torque figures are for reversible motors.

NB: Drain ports must be connected to tank via a dedicated drain line.