

Hydraulic Disc Brakes

Manufactured in China

Maxma BK2 series are a wet multi disc brake for use as static brakes in hydraulic systems. The braking action is applied by a series of springs applying force to friction discs which are attached to the output shaft.

Hydraulic pressure releases the spring force upon the discs.

These brakes are generally utilised on the output of torquemotors such as the Maxma MAP, MAR & MAS series.

NB: These brakes are used only as static parking brakes and are not recommended for dynamic braking applications.

Operating medium = Hydraulic oil to meet ISO6743/4

Operating Temperature range: -20°C - 90°C

Optimal Temperature Range: 20°C - 60°C

Filtration: 25um to ISO 20/16

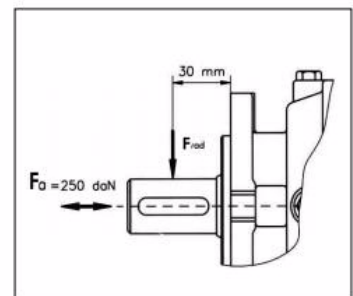
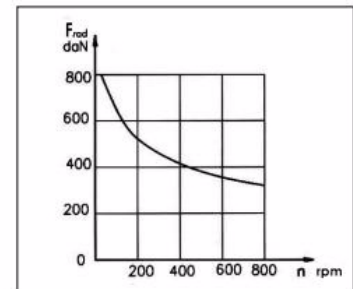
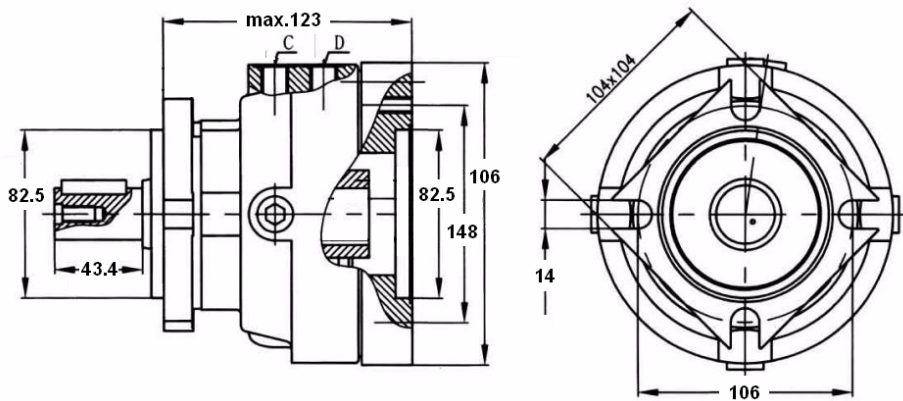
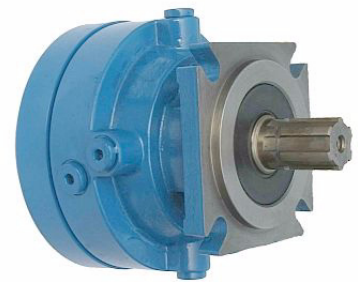

C Port = Drain Port 1/4"BSPP, charge with gear oil 220 cSt, use the uppermost port, fit a breather (130300021).
D Port = Brake release port 1/4"BSPP

Part No.	Static Torque Nm	Input Flange	Output Flange	Female Input Shaft	Male Output Shaft
BK2-1-430-B-B-00	410 - 450	SAE 'A'	SAE 'A'	32mm	32mm
BK2-1-430-C-C-00	410 - 450	SAE 'A'	SAE 'A'	1"	1"
BK2-1-430-E-C-00	410 - 450	SAE 'A'	SAE 'A'	1"6B	1"
BK2-1-430-E-E-00	410 - 450	SAE 'A'	SAE 'A'	1"6B	1"6B
BK2-1-430-G-G-00	410 - 450	SAE 'A'	SAE 'A'	1-1/4"	1-1/4"

Specification	Data
Min static torque (nm)	410 to 450
Min. releasing Pressure (bar)	17-23
Max. Operating Pressure (bar)	300
Min Displacement volume (cc)	7 - 8
charge oil volume (cc)	50-120
Max pressure on C port (bar)	0.05
Weight (kg)	9.5

TYPICAL CIRCUIT

