

# T20 Series - Foot Mounted - Shaft output Models

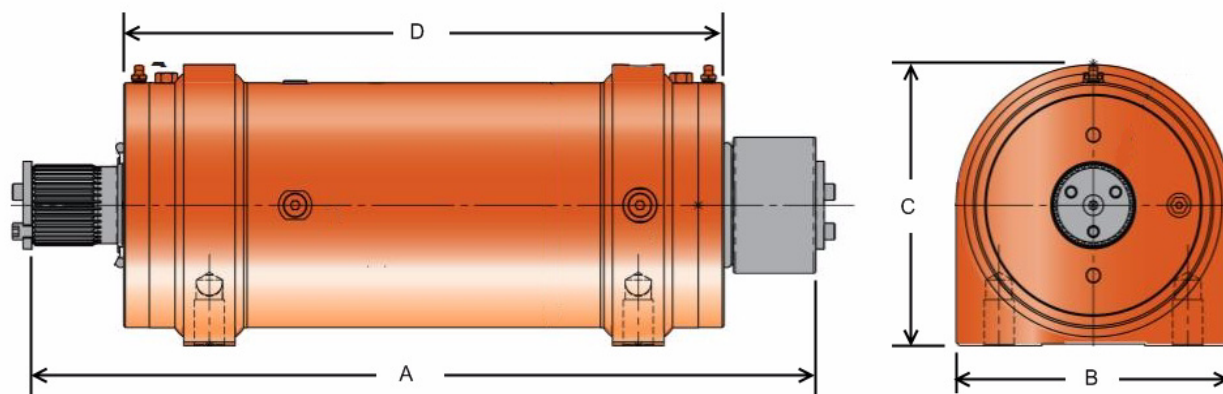

The T20 Series is ideal for applications where torque generation and higher cycle rates are the primary requirements. It features splined output shafts and 200-220 degrees of rotation. Helac's helical sliding spline technology is not self locking and provides high shock resistance and high holding torque for demanding applications.

Functioning as a rotating device, mounting bracket and load bearing structure, the T20 series eliminates the need for external bearing systems, brakes or locking devices. Three standard sizes with torque outputs up to 60,000 in/lbs at 3000 psi (6,780 Nm at 210 bar) are available.

**NB:** Custom rotation limits available on request

Description	Units	Size		
		25	45	60
<b>Drive Torque @ 210 bar</b>	in/lbs	25000	45000	60000
	Nm	2830	5090	6780
<b>Holding Torque</b>	in/lbs	54200	94900	127000
	Nm	6100	11000	14000
<b>Max. Moment Cap. Straddle</b>	in/lbs	37500	67500	90000
	Nm	4240	7630	10170
<b>Max. Radial Force</b>	kg	2040	3130	3900
<b>Max. Axial thrust</b>	kg	2040	3130	3900
<b>Displacement 220°</b>	cc	488	696	1180
<b>Approx. Weight</b>	kg	33.6	58.1	75.3
<b>Dim. A</b>	mm	417	546	579
<b>Dim. B</b>	mm	133	170	203
<b>Dim. C</b>	mm	143	174	203
<b>Dim. D</b>	mm	335	422	445

Part No.	Torque in/lbs	Degrees Rotation	Description
<b>T20-25-M-FT-220-DS-OH</b>	25000	220	Actuator
<b>T20-25-M-FT-220-DA-OH</b>	25000	220	Actuator + Splined Adaptors
<b>T20-45-M-FT-220-DS-OH</b>	45000	220	Actuator
<b>T20-45-M-FT-220-DA-OH</b>	45000	220	Actuator + Splined Adaptors
<b>T20-60-M-FT-200-DS-OH</b>	60000	200	Actuator
<b>T20-60-M-FT-200-DA-OH</b>	60000	200	Actuator + Splined Adaptors