

# Air-Oil Heat Exchangers - 2000KBV Series

Used for hydraulic system cooling on mobile and agricultural machines. This series is top-of-the-range and has an optimum price/efficiency ratio.

- Long-life aluminium body
- Integrated fixed thermostat: 60°C with 12°C differential (60-48°)
- Bypass valve
- Working pressure: 20 bar. Test pressure: 35 bar



Part Number	Technical Data												
	Supplier Code	V (AC)	Phase	Hz	kW	Amps	rpm	Ø Fan	dB(A)	Air Flow (m <sup>3</sup> /h)	IP	Max L/min	kg
<b>2W1501301</b>	MG-AIR-2015KBV-230	230	1	50/60	0.05/0.061	0.24-0.28	2740/3120	200	68	700	44	80	7
<b>2W1503301</b>	MG-AIR-2015KBV-400	230-400	3	50	0.068	0.29-0.17	2500		69	720			
<b>2W2001301</b>	MG-AIR-2020KBV-230	230	1	50/60	0.05-0.061	0.24-0.28	2740/3120	68	675	100		8	
<b>2W2003301</b>	MG-AIR-2020KBV-400	230-400	3	50	0.068	0.29-0.17	2500		645				
<b>2W2401301</b>	MG-AIR-2024KBV-230	230	1	50/60	0.115/0.150	0.51-0.66	2450/2600	250	72	1350	120	11	
<b>2W2403301</b>	MG-AIR-2024KBV-400	230-400	3	50	0.105	0.33-0.19	2600			1300			
<b>2W3001301</b>	MG-AIR-2030KBV-230	230	1	50/60	0.23/0.35	1.1-1.55	2700/3000	300	78	2220	140	15	
<b>2W3003301</b>	MG-AIR-2030KBV-400	230-400	3	50	0.21	0.62-0.36	2580		76	2500			
<b>2W4001301</b>	MG-AIR-2040KBV-230	230	1	50/60	0.16/0.24	0.73-1.06	1430/1700	400	71	3200	160	21	
<b>2W4003301</b>	MG-AIR-2040KBV-400	230-400	3	50	0.135	0.76-0.44	1450			3200			
<b>2W5003301</b>	MG-AIR-2050KBV-400	230-400	3	50	0.52	1.9-1.1	1450	450	76	5000	180	27	
				60	0.66	2-1.2	1690						

Note: The above coolers are equipped with bypass valve and fixed thermostat 60-48°. For sizing the cooler please contact your local Southcott branch.

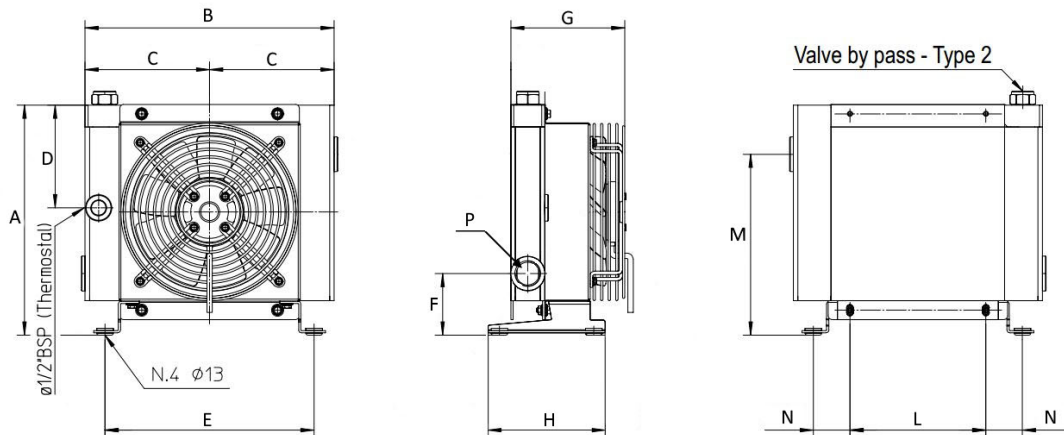

Part No.	Dimensions (mm)											
	A	B	C	D	E	F	G	H	L	M	N	P
<b>2W1501301/2W1503301</b>	304.5	330	165	136	277	81.5	151	155	180	239.5	48.5	Ø 1" BSP
<b>2W2001301/2W2003301</b>							169					
<b>2W2401301/2W2403301</b>	365.5	390	195	174	327	82.5	169.5	155	240	300.5	43.5	
<b>2W3001301/2W3003301</b>	429.5	455	227.5	198.5	392	81.5	188	155	310	364.5	41	
<b>2W4001301/2W4003301</b>	533	550	275	260.5	487	79	204	155	400	468	43.5	Ø 1-1/4 BSP
<b>2W5003301</b>	650	605	302.5	-	-	-	273	230	-	-	-	

## Performance & Pressure Drop Diagrams

Performance Diagram

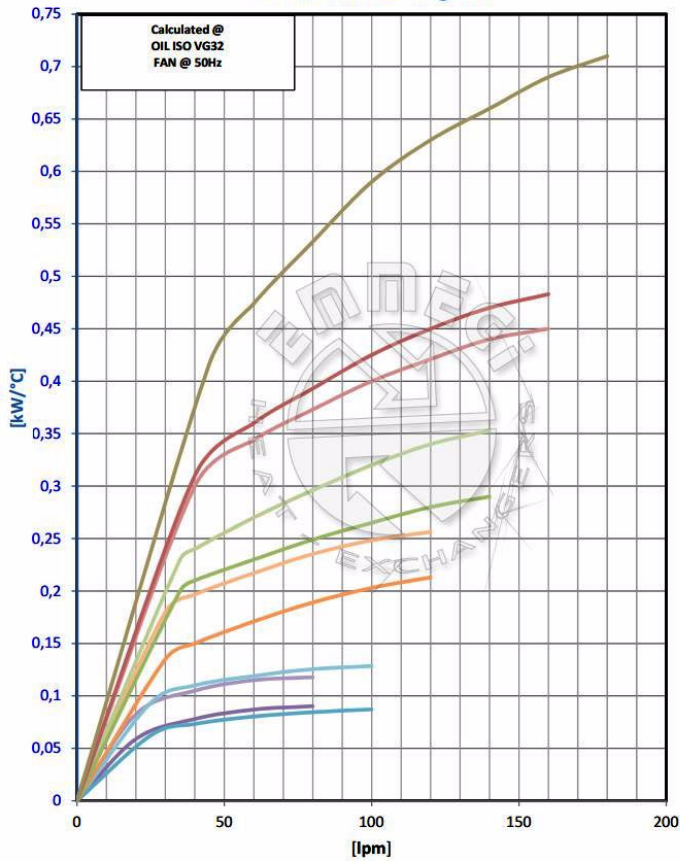

- 2015KBV - S.C.P. - AC
- 2020KBV - S.C.P. - B114
- 2030KBV - S.C.P. - AC
- 2040KBV - S.C.P. - B14
- 2015KBV - S.C.P. - B14
- 2024KBV - S.C.P. - AC
- 2040KBV - S.C.P. - B14
- 2050KBV - S.C.P.
- 2020KBV - S.C.P. - AC
- 2024KBV - S.C.P. - B14
- 2040KBV - S.C.P. - AC

Pressure Drop Diagram

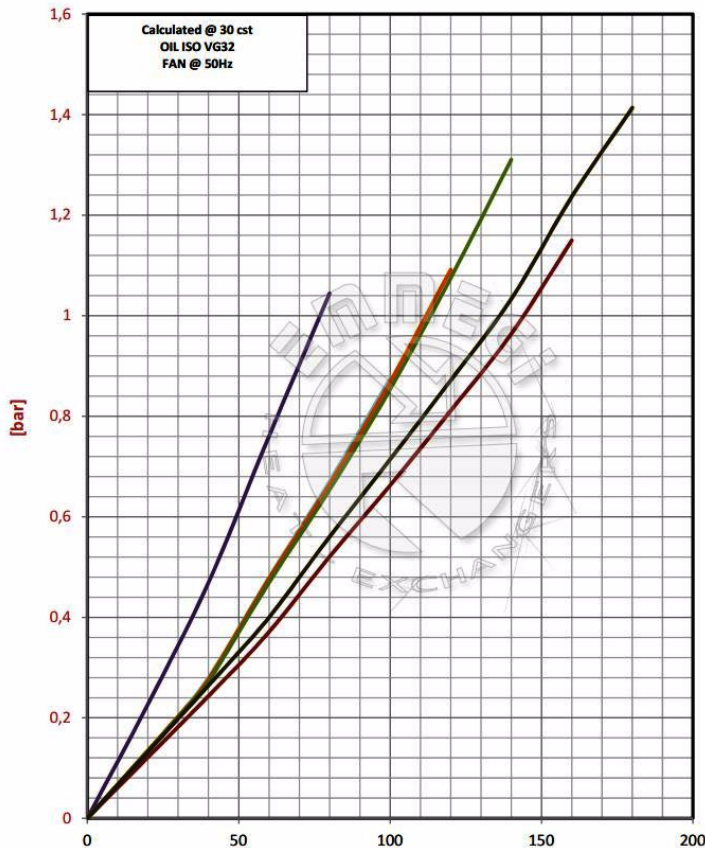

- 2015KBV - Press. Drop
- 2030KBV - Press. Drop
- 2020KBV - Press. Drop
- 2040KBV - Press. Drop
- 2024KBV - Press. Drop
- 2050KBV - Press. Drop